

Safety & Maintenance

- Always ensure the power is switched off and allow the LED fixture to cool completely before carrying out any maintenance, cleaning, or adjustments.
- This product must be installed and serviced by a properly qualified and licensed electrician.
- Ensure the product is properly installed and confirmed safe for operation before reconnecting the electrical supply.
- Always use clean gloves when handling the fixture to prevent fingerprints, stains, or surface contamination.
 - Use microfiber cloths to remove dust.
 - Use a cleaner with antistatic properties for fingerprints and spots.
- Prevent flammable materials from accumulating on the luminaire housing.
- Prevent water or any other liquid from accumulating on the luminaire housing.
- Do not dispose with normal waste.



INSTALLATION AND MAINTENANCE MANUAL

LED PANEL LIGHT

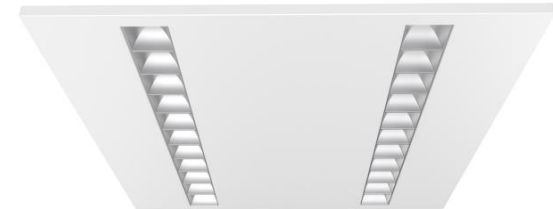

Installation instructions

- Open the package, remove the fixture and all accessories, verify the package include the mounting bracket, anchors or bolts, (if applicable), Allen key, screws and connectors; place them on a clean flat surface in view until installation is complete, and ensure the necessary tools (e.g., screwdriver, drill with bit, level, ladder, electrical tester) before proceeding.

Wiring the fixture:

- Turn off the power supply before proceeding and connect the fixture's 'Live' wire to the power supply's live terminal and the 'Neutral' wire to the neutral terminal, ensuring correct polarity for safe operation. (Refer to images 4 & 5)
- Confirm the fixture's compatibility, dimming functions, and wiring specifications before direct connection to the power supply.
- Refer to images for different configuration, **On/Off** (Refer to image 4); **Triac Dimming** (Refer to image 5); **1-10 V Dimming** (Refer to image 5); **DALI Dimming** (Refer to image 6) and ensure all connections are secure before turning on the power supply.

Installation:

- Mark the location on the ceiling, then remove any existing ceiling tile or panel (or for drywall, cut an opening according to the size of the panel. , and place the driver inside the ceiling and connect the AC main supply to the driver's input terminals. (Refer to image 2 and (follow [Wiring the fixture](#))
- Connect the LED Panel light to the output terminal of the driver.
- Insert the panel into the ceiling opening and firmly secure it above the ceiling structure and make sure the panel sits flush with the ceiling surface and there are no gaps.(Refer to image 3)

Installation Diagram

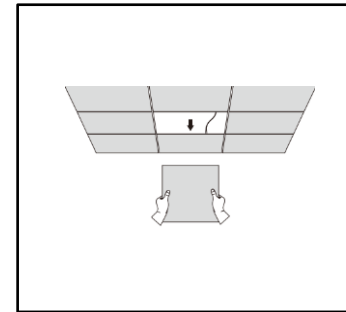

IMAGE 1

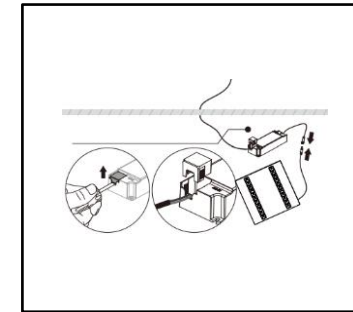

IMAGE 2

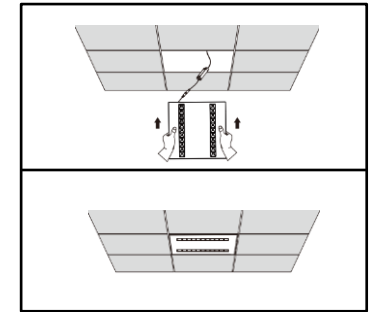

IMAGE 3

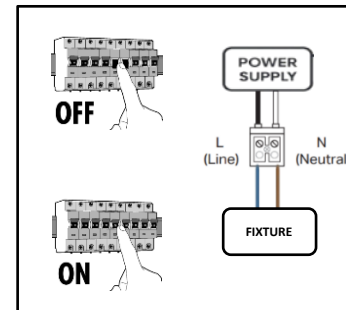

IMAGE 4

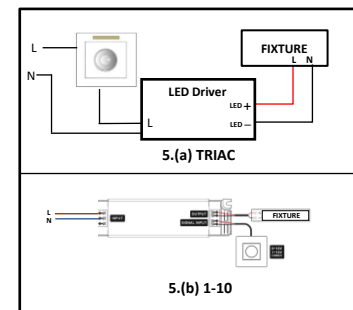

IMAGE 5

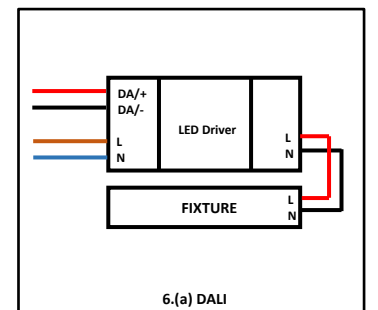

IMAGE 6

Dos and Don'ts

- Overloading Electrical Circuit: Avoid connecting too many fixtures to a single circuit.
- Use only manufacturer-provided accessories to prevent damage and ensure proper functionality.
- Avoid mounting on unstable, weak, or uneven surfaces that cannot support the fixture's weight.
- **Any unauthorized modification of the fixture or non-compliance with the above instructions will result in voiding the product warranty.**
- **Avoid impacts and drilling, as exposed PCBs and drivers are vulnerable and easily damaged during installation or maintenance.**
- **Do not install or operate this equipment near open flames or flammable materials to prevent fire hazards. (Refer to image 9)**
- **Avoid lifting the fixture by its input cables to prevent damage to the wiring or internal connections.**
- **Avoid overtightening fasteners when mounting the luminaire, as excessive torque can damage the fixture or cause fastener failure. during installation or maintenance.**



IMAGE 7

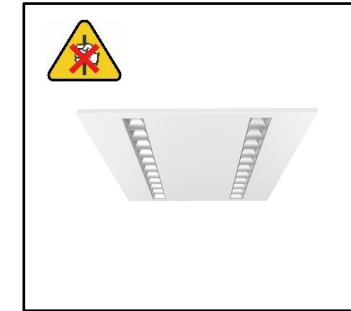

IMAGE 8



IMAGE 9