

Safety & Maintenance

- Always ensure the power is switched off and allow the LED fixture to cool completely before carrying out any maintenance, cleaning, or adjustments.
- This product must be installed and serviced by a properly qualified and licensed electrician.
- Ensure the product is properly installed and confirmed safe for operation before reconnecting the electrical supply.
- Always use clean gloves when handling the fixture to prevent fingerprints, stains, or surface contamination.
 - Use microfiber cloths to remove dust.
 - Use a cleaner with antistatic properties for fingerprints and spots.
- Prevent flammable materials from accumulating on the luminaire housing.
- Prevent water or any other liquid from accumulating on the luminaire housing.
- Do not dispose with normal waste.



INSTALLATION & MAINTENANCE MANUAL

LED CANOPY LIGHT

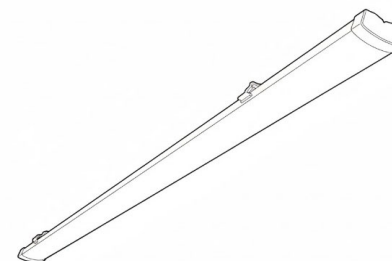

Installation instructions

- Open the package, remove the fixture and all accessories, verify the package include the mounting bracket, anchors or bolts, (if applicable), Allen key, screws and connectors; place them on a clean flat surface in view until installation is complete, and ensure the necessary tools (e.g., screwdriver, drill with bit, level, ladder, electrical tester) before proceeding.

Wiring the fixture:

- Turn off the power supply, then connect the fixture's Live, Neutral, and Ground wires to their respective terminals to the power supply, ensuring correct polarity for safe operation. (Refer to images 4)
- Confirm the fixture's compatibility, dimming functions, and wiring specifications before direct connection to the power supply.
- Refer to images for different configuration, **On/Off** (Refer to image 4); **1–10 V Dimming** (Refer to image 5); **DALI Dimming** (Refer to image 6) and ensure all connections are secure before turning on the power supply.

Installation:

- Mark and drill screw holes using the pre-installed bracket on the fixture as a reference, then detach the bracket and fix it to the ceiling surface. (Refer to image 1)
- Align the luminaire's rear mounting slot with the installed metal bracket, then gently press it into the clips until it locks securely in place. (Refer to image 2 & 3)

Dos and Don'ts

- Use only manufacturer-provided accessories to prevent damage and ensure proper functionality
- Use waterproof connectors and accessories to maintain the fixture's IP rating and ensure proper protection.
- Overloading Electrical Circuit: Avoid connecting too many fixtures to a single circuit.
- Avoid impacts and drilling, as exposed PCBs and drivers are vulnerable and easily damaged during installation or maintenance.**
- Avoid lifting the fixture by its input cables to prevent damage to the wiring or internal connections.**
- Do not install or operate this equipment near open flames or flammable materials to prevent fire hazards.(Refer to image 9)**
- Avoid overtightening fasteners when mounting the luminaire, as excessive torque can damage the fixture or cause fastener failure. during installation or maintenance.**

Installation Diagram

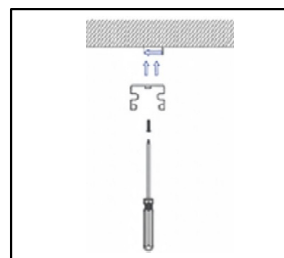

IMAGE 1

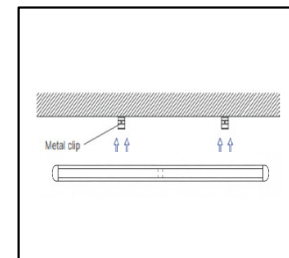

IMAGE 2

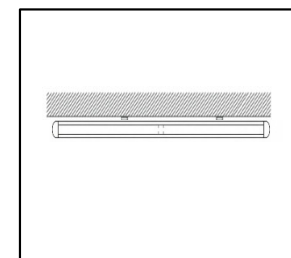

IMAGE 3

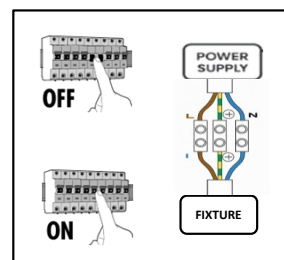

IMAGE 4

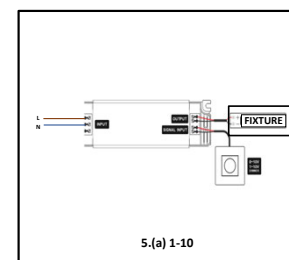

IMAGE 5

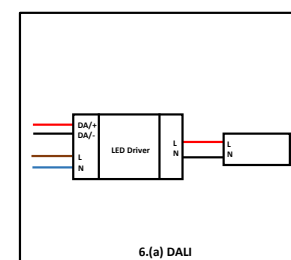

IMAGE 6

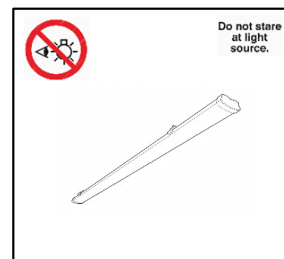

IMAGE 7

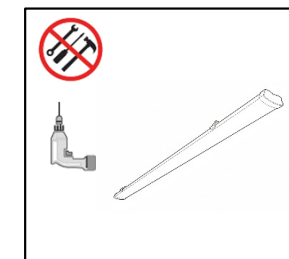

IMAGE 8

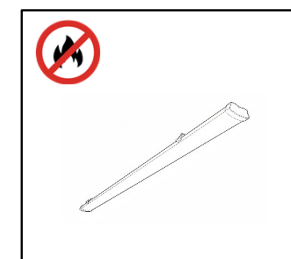

IMAGE 9