

Safety & Maintenance

- Always ensure the power is switched off and allow the LED fixture to cool completely before carrying out any maintenance, cleaning, or adjustments.
- This product must be installed and serviced by a properly qualified and licensed electrician.
- Ensure the product is properly installed and confirmed safe for operation before reconnecting the electrical supply.
- Always use clean gloves when handling the fixture to prevent fingerprints, stains, or surface contamination.
 - Use microfiber cloths to remove dust.
 - Use a cleaner with antistatic properties for fingerprints and spots.
- Prevent flammable materials from accumulating on the luminaire housing.
- Prevent water or any other liquid from accumulating on the luminaire housing.
- Do not dispose with normal waste.



INSTALLATION AND MAINTENANCE MANUAL

LED Track Light

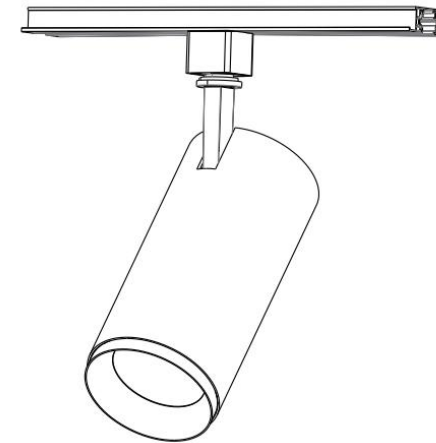

Installation instructions

- Open the package, remove the fixture and all accessories, verify the package include the mounting bracket, anchors or bolts, (if applicable), Allen key, screws and connectors; place them on a clean flat surface in view until installation is complete, and ensure the necessary tools (e.g., screwdriver, drill with bit, level, ladder, electrical tester) before proceeding.
- **Wiring the fixture:**
- Turn off the power supply before proceeding and connect the fixture's 'Live' wire to the power supply's live terminal and the 'Neutral' wire to the neutral terminal, ensuring correct polarity for safe operation. (Refer to images 4 & 5)
- Confirm the fixture's compatibility, dimming functions, and wiring specifications before direct connection to the power supply.
- Refer to images for different configuration, **On/Off** (Refer to image 4); **Triac Dimming** (Refer to image 5); **1-10 V Dimming** (Refer to image 5); **DALI Dimming** (Refer to image 6) and ensure all connections are secure before turning on the power supply.
- Route the AC wiring through the base aperture where the luminaire will be installed.

Installation:

- Hold the track up to the ceiling or wall, align the screw holes, mark and drill at those points, then secure the track firmly with appropriate screws. (Refer to image 1)
- Insert the Track Light with adapter into the track and insert the adapter towards the polarity until the latch locks into track and screw it. (Refer to image 2 & 3)
- Connect the wires from the Track Light fixture to the wires in the electrical box. Use wire connectors to secure the connections.
- Before inserting the fixture into the track, turn the locking clip by rotating one end **anticlockwise** and the other end **clockwise** to secure the fixture into the track. (Refer to image 7)
- Insert the fixture into the track by aligning its two locking clips, push gently until they engage, and rotate the locking clip in opposite direction (Refer to image 8) and once secured the light will turn on. (Refer to image 8) .
- To power more than one lamp, on the same track, connect the neutral wire of each additional lamp's cable to the common "N" terminal, Again, just add one of the cable-ends to the "N" terminal. The other end of the cable needs to be connected to "L2" or "L3".

Installation Diagram

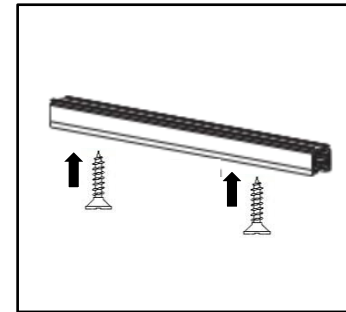

IMAGE 1

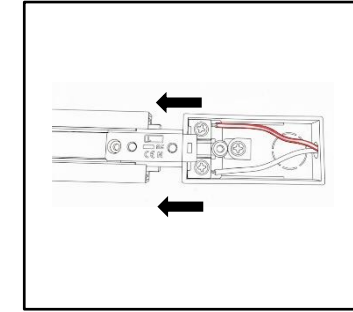

IMAGE 2

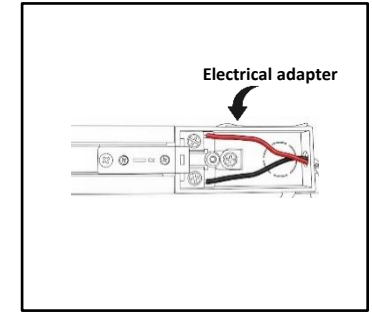

IMAGE 3

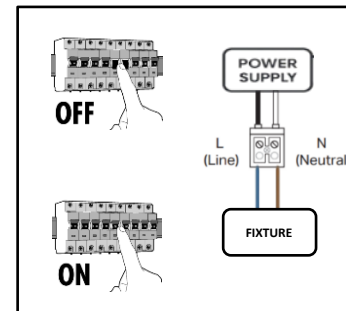

IMAGE 4

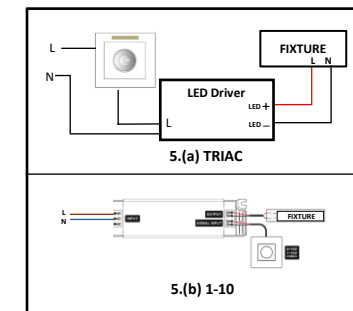

IMAGE 5

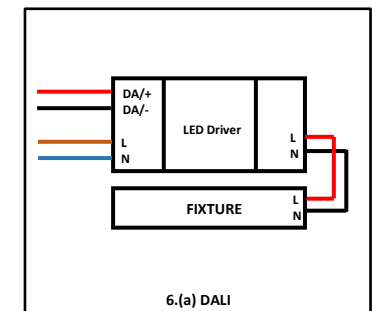

IMAGE 6

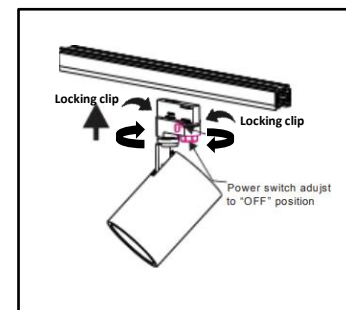

IMAGE 7

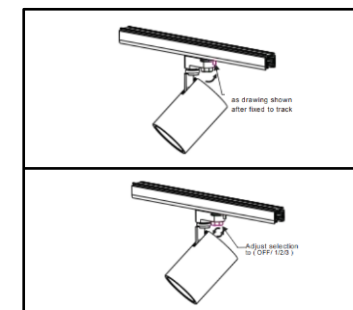

IMAGE 8

Dos and Don'ts

- Use only manufacturer-provided accessories to prevent damage and ensure proper functionality.
- Overloading Electrical Circuit: Avoid connecting too many fixtures to a single circuit.
- **Any unauthorized modification of the fixture or non-compliance with the above instructions will result in voiding the product warranty.**
- **Avoid impacts and drilling, as exposed PCBs and drivers are vulnerable and easily damaged during installation or maintenance.**
- **Do not install or operate this equipment near open flames or flammable materials to prevent fire hazards. (Refer to image 11)**
- **Avoid lifting the fixture by its input cables to prevent damage to the wiring or internal connections.**
- **Avoid overtightening fasteners when mounting the luminaire, as excessive torque can damage the fixture or cause fastener failure. during installation or maintenance.**

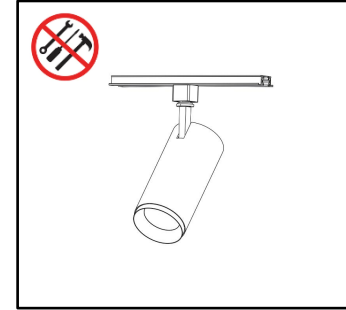

IMAGE 9

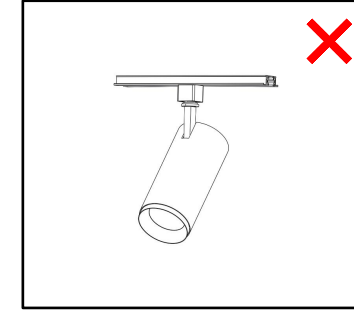

IMAGE 10

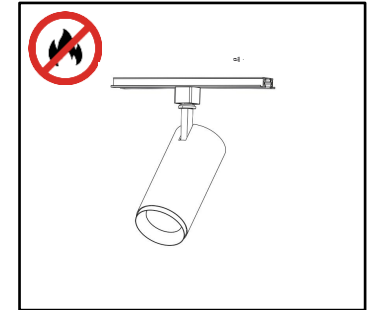

IMAGE 11